



Fael Security Srl  
Via E. Majorana  
72100 Brindisi - ITALIA  
Tel. 0831-546563 Fax 0831-546674  
E-mail: fael@fael.com  
Web: http://www.fael.com

# VECTRALUX

FIXED GLAZED DOOR - EI 60  
(STEEL PROFILE)

Client: \_\_\_\_\_

Order n° \_\_\_\_\_ date \_\_\_\_\_

Ref. : \_\_\_\_\_

Rev. 0 - 02/04/2021

EN 1364-1 :2015

## FIXED GLAZED DOOR - STEEL PROFILE - EI 60

ACC F60.en

3

### HALLWAY ASSEMBLY

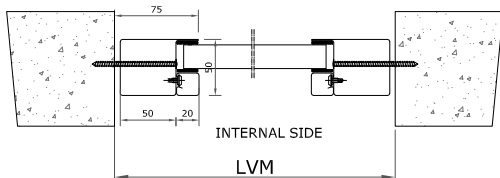

N.B.: 4 SIDES "L" PROFILE

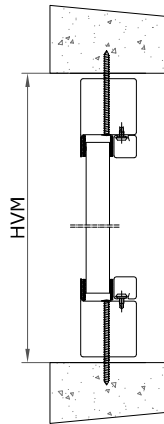

3a

### CORNER ASSEMBLY

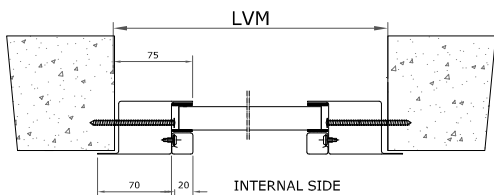

N.B.: 4 SIDE "Z" PROFILE

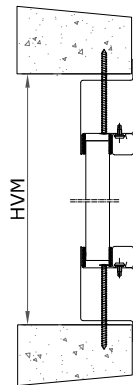

3b

### CORNER ASSEMBLY

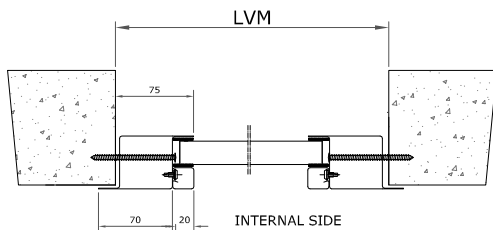

N.B.: 4 SIDE "Z" PROFILE  
"L" PROFILE ON LOWER SIDE

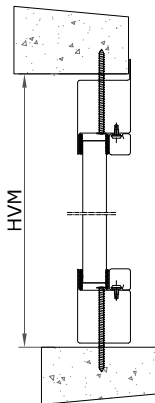

### Fixed glazed door Type

(cross the chosen type)

	A	B
1		
*Dim. MAX = LxH = 1500 x 2000 mm		
2		

\* FOR DIMENSIONS EXCEEDING THE LARGEST SIZE, PLEASE CONTACT THE TECHNICAL OFFICE

#### Glass Specificy:

- EI 60 glass (internal use)
- EI 60 glass (external use)

Assembly (specify): 3  3a  3b

RAL: \_\_\_\_\_

Note: \_\_\_\_\_

MANSORY ASSEMBLY

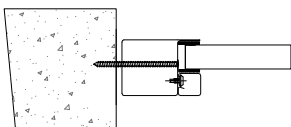

PLASTERBOARD ASSEMBLY

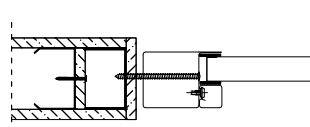

Glazed Dimensions (LVM x HVM ) mm

LVM \_\_\_\_\_ x HVM \_\_\_\_\_  
(Struct. opening Width) x (Struct. opening Height)

Stamp and Signature

Date