



Fael Security Srl  
Via E. Majorana  
72100 Brindisi - ITALIA  
Tel. 0831-546563 Fax 0831-546674  
E-mail: fael@fael.com  
Web: http://www.fael.com

# VECTRALUX

VITREE FIXE EI 60  
(PROFIL EN ACIER)

Client: \_\_\_\_\_

Cde n° \_\_\_\_\_ du \_\_\_\_\_

Ref. : \_\_\_\_\_

Rev. 0 - 02/04/2021

EN 1364-1 :2015

## VITREE FIXE - PROFIL EN ACIER - EI 60

ACC F60.fr

### 3 MONTAGE COULOIR

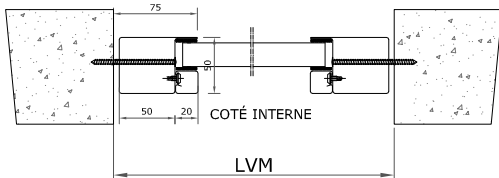

N.B.: PROFIL A "L" SUR 4 COTES

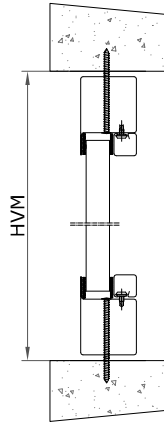

### 3a MONTAGE EN ANGLE

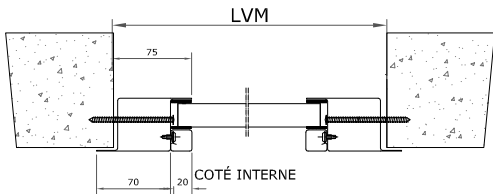

N.B.: PROFIL A "Z" SUR 4 COTES

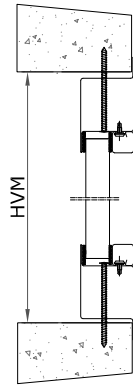

### 3b MONTAGE EN ANGLE

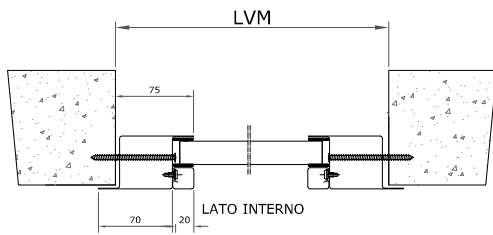

N.B.: PROFIL A "Z" SUR 3 COTES  
PROFIL "L" SUR COTE INFERIEUR

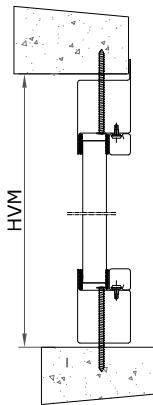

MONTAGE SUR MAÇONNERIE

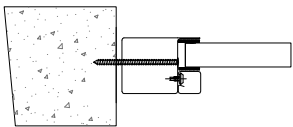

MONTAGE SUR MUR EN  
PLAQUES DE PLÂTRE

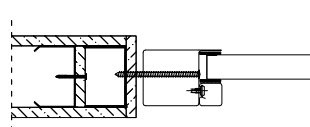

### Typologie vitrée fixe

(cochez la typologie choisit)

	A	B
1		
*Dim. MAX = LxH = 1500 x 2000 mm		
2		

\* POUR LES DIMENSIONS EXCÉDANT LES  
DIMENSIONS MAXIMALES : VEUILLEZ CONTACTER  
LE SERVICE TECHNIQUE

choisissez le vitrage:

Vitrage EI 60 (usage interne)

Vitrage EI 60 (usage externe)

Montage (choisissez): 3  3a  3b

RAL: \_\_\_\_\_

Note: \_\_\_\_\_

Dimensions Vitrée (LVM x HVM ) mm

LVM \_\_\_\_\_ x HVM \_\_\_\_\_  
(Largeur baie) x (Hauteur Baie)

Timbre et signature

Date